

GuttaCore®

Travel challenging canals with confidence

Dentsply
Sirona
Endodontics

The hydraulics advantage

Many obturation techniques use lateral or vertical compaction of gutta-percha. However, the hydraulic force from these techniques generally moves gutta-percha in one or two unequal directions (laterally or apically). GuttaCore is different. Its crosslinked gutta-percha core centrally compacts the gutta-percha with a hydraulic force that sends it flowing equally in three dimensions - throughout the entire canal system. It removes easily, too.

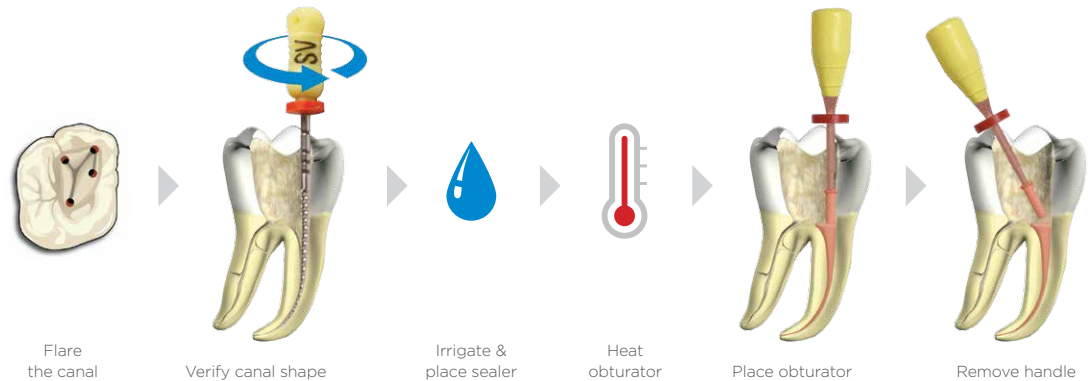

Oven operation

GuttaCore® obturation instructions

1. Hold the oven button down for 2 seconds to power on. Push the button to select the correct obturator size (Size 1 for all GuttaCore sizes).
2. Disinfect the obturator in a 5.25% NaOCl solution for one minute. Gently wipe the gutta-percha on the obturator with 2" x 2" gauze moistened with 70% alcohol.
3. Seat the obturator with the silicone stopper below the arm.
4. Start heating by pushing the oven arm down to place the obturator into the heating chamber. After the first signal "beep," press again to release the oven arm and remove the obturator.



1. Flare the canal coronally to ensure the GuttaCore obturator has sufficient space to enter the root canal along the straight line access.
2. Verify the shape of the canal with a size verifier. Ensure 360 degree rotation at working length. **Do not use a hand file.** The .02 taper will not verify the obturator taper and shape desired.

Note: *The size verifier may be used as a finishing file to gently enlarge the canal terminus, or select a smaller size verifier.*

3. Take a radiograph to confirm that the size verifier has reached the working length.
4. Select the corresponding obturator size. Use the same size obturator when finishing at a .06 taper or when using WaveOne® Gold. Select one size smaller than the last file taken to working length when finishing at a .04 taper.
5. Irrigate the canal and dry with absorbent points. Apply a very thin coating of sealer throughout the canal system. Remove excess sealer with additional paper points.

6. Set the silicone stopper at working length using the calibration marks on the size verifier prior to placement.
7. Heat the obturator in the oven.
8. Place into the canal with one continuous motion (7-10 seconds from oven to placement) to the working length. For posterior placement remove handle before placing into the canal.
9. Remove the GuttaCore handle at the orifice by bending side to side, using a round bur, or an inverted cone bur, or a sharp spoon excavator.

Tip: *Fill one canal at a time. To avoid overflow of gutta-percha, place absorbent points in the unfilled canals. Clean the canal chamber and create an occlusal leakage barrier with a composite restorative.*

Posterior Placement: After heating in the oven, hold GuttaCore with cotton pliers, remove the handle by bending side to side and place to working length.

Post Space and Retreatment: Use traditional methods for creating post space or for removing obturation material. See GuttaCore DFU for more information.

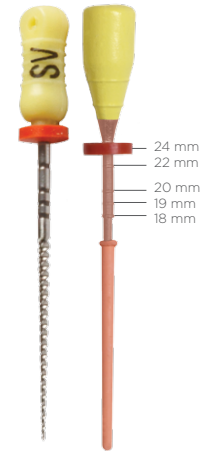

Single use



Storage temperature



Open packages are not replaced



Consult instructions for use