

X-SMART IQ™

Getting Started Guide



1 Package Contents

Image Uneditable

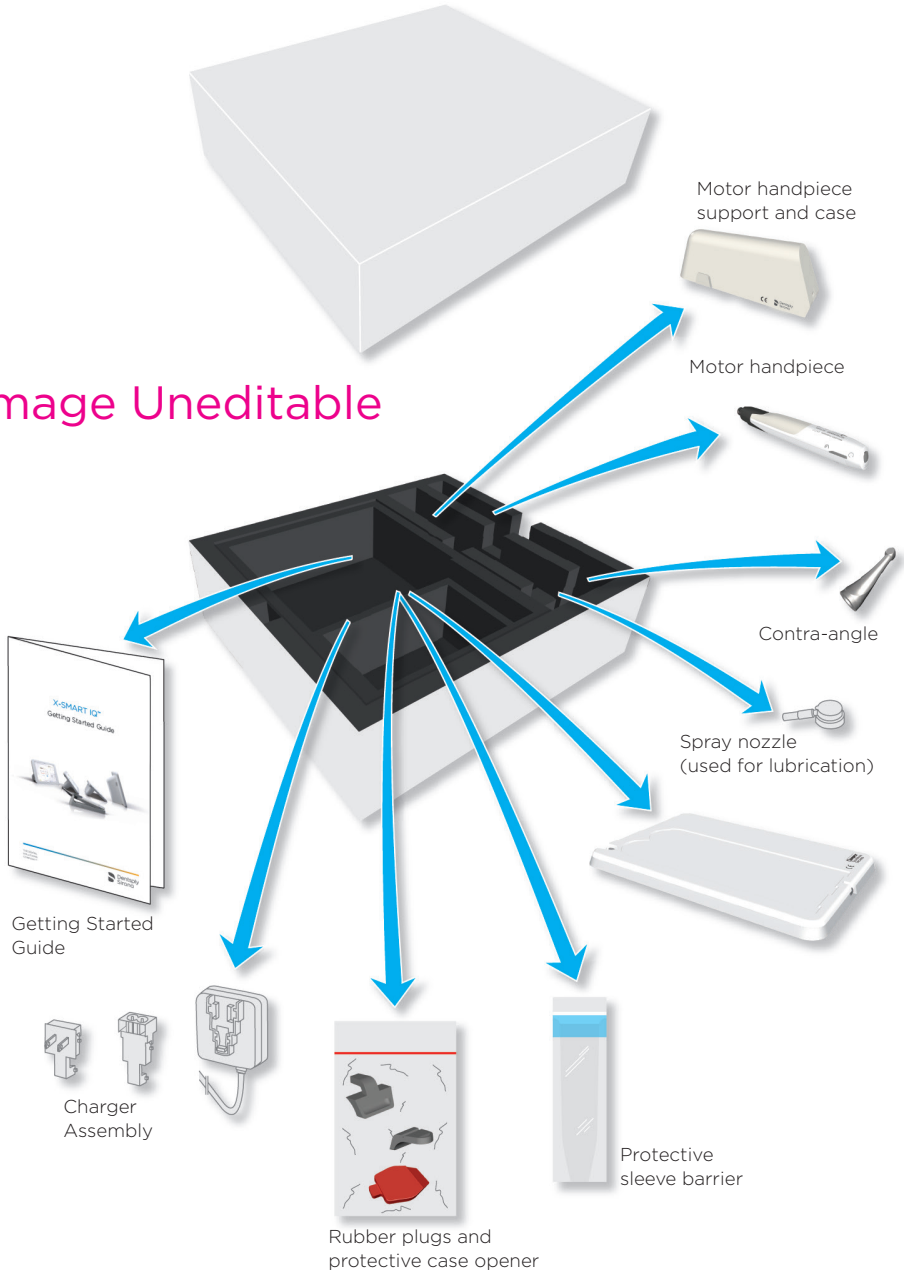

2 iPad® set-up

- A** **Activate the AssistiveTouch feature**
The AssistiveTouch feature allows to emulate the iPad Home button which is not accessible when in the protective case.



- B** **Activate the Bluetooth®**
The connection between the motor handpiece and the application is done via Bluetooth®.



- C** **Activate the Wi-Fi**
Wi-Fi is necessary to download the application from the Apple Store®.



Select the Wi-Fi network and enter your password to connect the iPad.

- D** **Set the volume to maximum**



- E** **Download the application from the Apple Store®**



If you do not already have an Apple ID, follow the procedure on the "<http://www.apple.com/support/appleid/>" website.

3 Protective Handpiece Case Setup

(A) Enclose the iPad mini™ in the protective case and place the rubber plugs on the camera and the charging port.

(B) Separate the motor handpiece cover from the motor handpiece support.

Need new images and copy

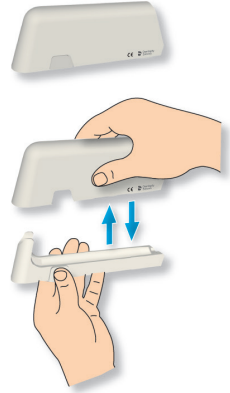

Insert copy about protective sleeves?

(C) Install the motor handpiece case as protective case holder.

copy correct?



4 Pairing the Motor Handpiece to the App

- A Open the application.



- B Press the multi-function button and check that the Bluetooth® blue LED is blinking.



- C Wait a few seconds until the application detects the motor handpiece.



- D Check the motor handpiece serial number and click on the corresponding number on the iPad screen.



- E When the motor handpiece is connected, the icon changes and the Bluetooth® LED stops blinking.



5 Application

Access to user data and logout

Consult and edit treatment reports

Consult the file library and create or edit file sequences

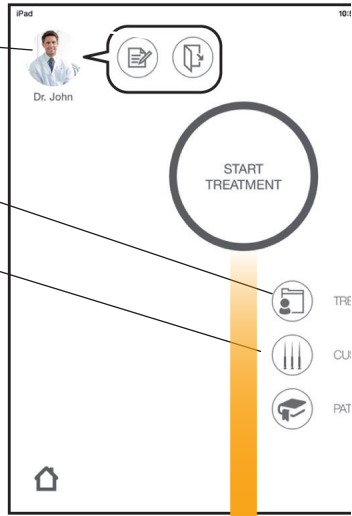

Start Treatment

Adjust torque and speed parameters

Enable or disable the auto-reverse function

Motor handpiece calibration

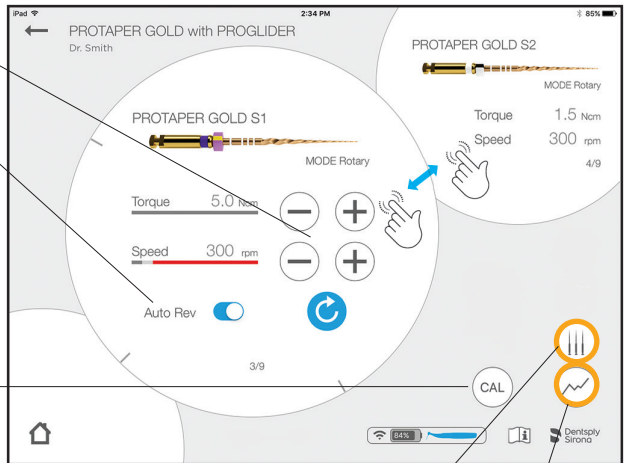

Select your file sequence (or file system)

Visualize the torque that was applied to the file

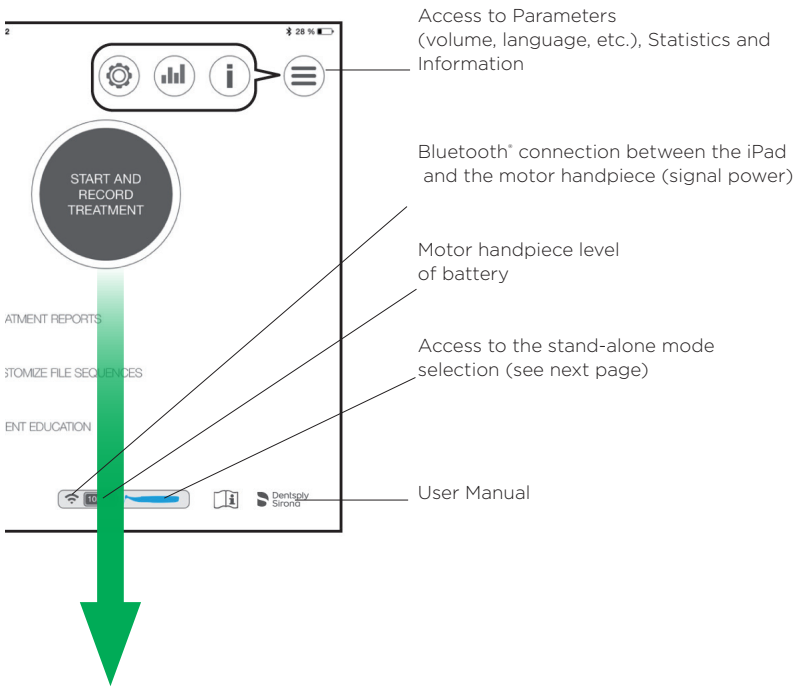

Start and Record Treatment

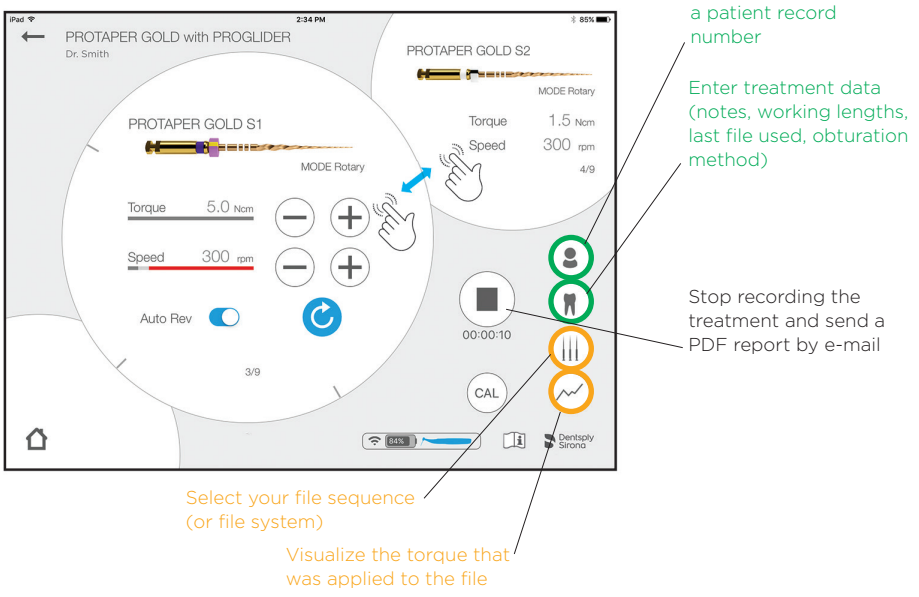

6 Motor Handpiece

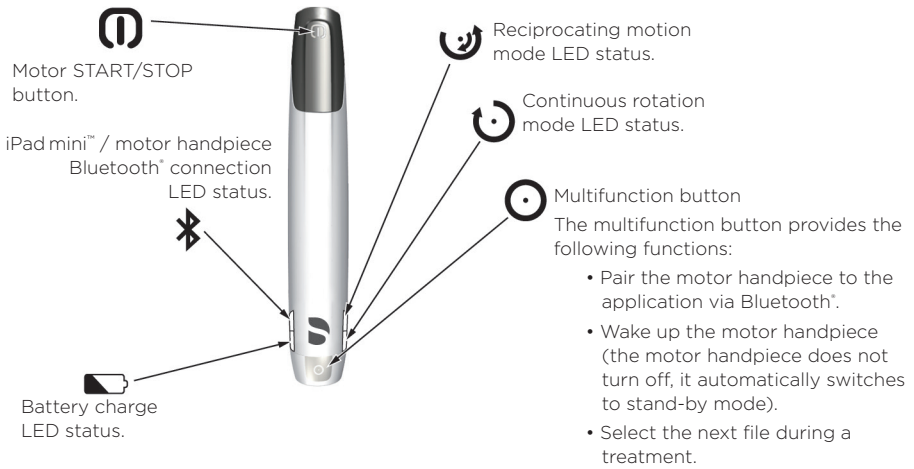

Stand-alone Mode

The stand-alone mode allows you to work without the iPad. After the first connection, if you turn on the motor handpiece without connecting it to the iPad, it will run with the stand-alone mode settings.

How to set the stand-alone mode

A From the application tap on this icon



B Select between Continuous or Reciprocating stand-alone modes.

95%

Running time : 0h

S/N : AAAAA

Version SW :

Manufacturer : MSA

Update to SW X.X.Y

Stand-alone mode:

Continuous

Torque 2.0 Ncm

Speed 300 rpm

AUTO-REV

Reciprocating

AUTO-REV

Functional test

Disconnect

Help to identify a problem and verify the status of the motor handpiece

Disconnect the motor handpiece

7 After use

Store and charge the motor handpiece

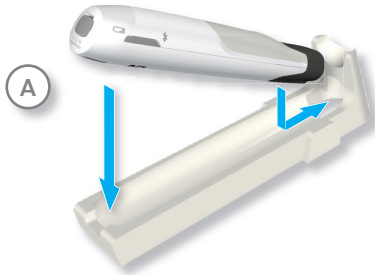

Full recharge: 6 hours

Autonomy: 2 days with 8 treatments per day (= 16 treatments in total).

It is recommended to fully charge the motor handpiece battery before using the first time. Do not use any other charger than the one supplied.

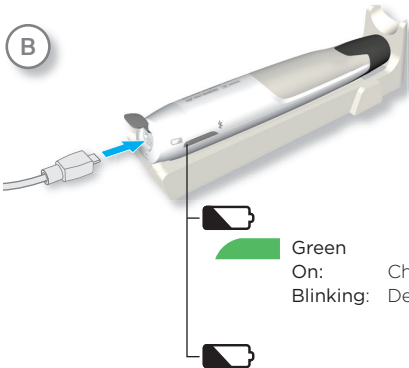

Green

On: Charged.
Blinking: Device charging.



Red

On: Low battery.
Blinking: Critical low battery.
Do not use on patient until charged.

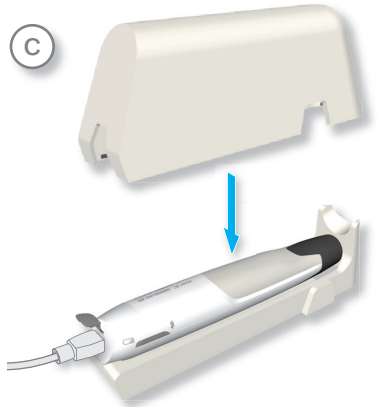

Insert copy about protective sleeves?

8 Disinfection and cleaning

Foreword

For hygiene and sanitary safety purposes, the contra-angle must be cleaned, disinfected and sterilized before each usage to prevent any contamination. This concerns the first use, as well as all subsequent uses. The use of a protective barrier sleeve is highly recommended.

Motor handpiece

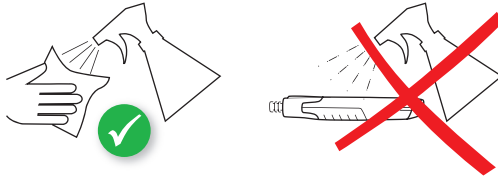

Do not spray cleaning solutions directly on the motor handpiece.





When subjecting the motor handpiece to a wipe-down disinfection, ensure that the charging cable is not connected and that the charging socket is closed.

iPad™ Stand



Do not spray cleaning solutions directly on the stand.

General recommendations

-  Do not use chloride detergent materials.
-  Do not use bleach or chloride disinfectant materials.
-  Do not spray solution directly on protective case or motor handpiece.

 Use only a disinfecting solution which is approved for its efficacy (VAH/DGHM-listing, CE marking, FDA and Health Canada approval) and in accordance with the DFU of the disinfecting solution manufacturer.

9 Helpful hints

Multi-function button



Press the multi-function button to switch to the next file.

To reset the motor handpiece, press the multi-function button for 10 seconds.

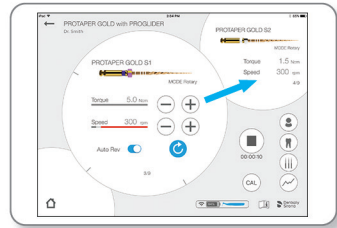

Close an application

Pinch 4 or 5 fingers together to close an application and return to the home screen.

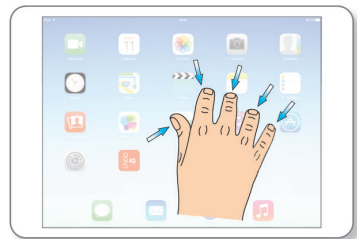
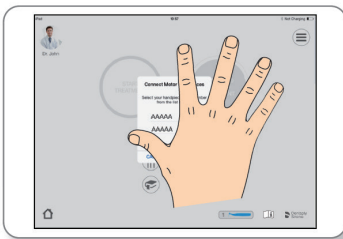

10 Additional Information



This document does not replace the User Manual. Please carefully read the User Manual that is available from any page of the application through this icon  and on dentsplysirona.com.

If you wish to have a printed version of your User Manual, we will be happy to send you a copy free of charge. Please call 1-800-662-1202.

You can also find more information (tutorial videos, helpful hints, FAQ) on dentsplysirona.com/x-smartIQ.

For additional support, please call 1-800-662-1202.



Check regularly for updates on the Apple Store*.



Always check the application compatibility on  before updating iOS on your iPad.

Apple, and iPad are trademarks of Apple Inc., registered in the U.S. and other countries. App Store is a service mark of Apple Inc. iOS is a trademark or registered trademark of Cisco in the U.S. and other countries and is used under license. The Bluetooth® word mark and logos are registered trademarks owned by Bluetooth SIG, Inc. and any use of such marks by Dentsply Sirona is under license.

DENTSPPLY Tulsa Dental Specialties
Dentsply Sirona
608 Rolling Hills Dr.
Johnson City, TN 37604
1-800-662-1202
For the latest information consult
www.Dentsply.com
www.Dentsply.com/endo-patents



Rx Only
For Dental Use Only